

Low Level Balanced Flue Kit (FBF)

The kit comprises:

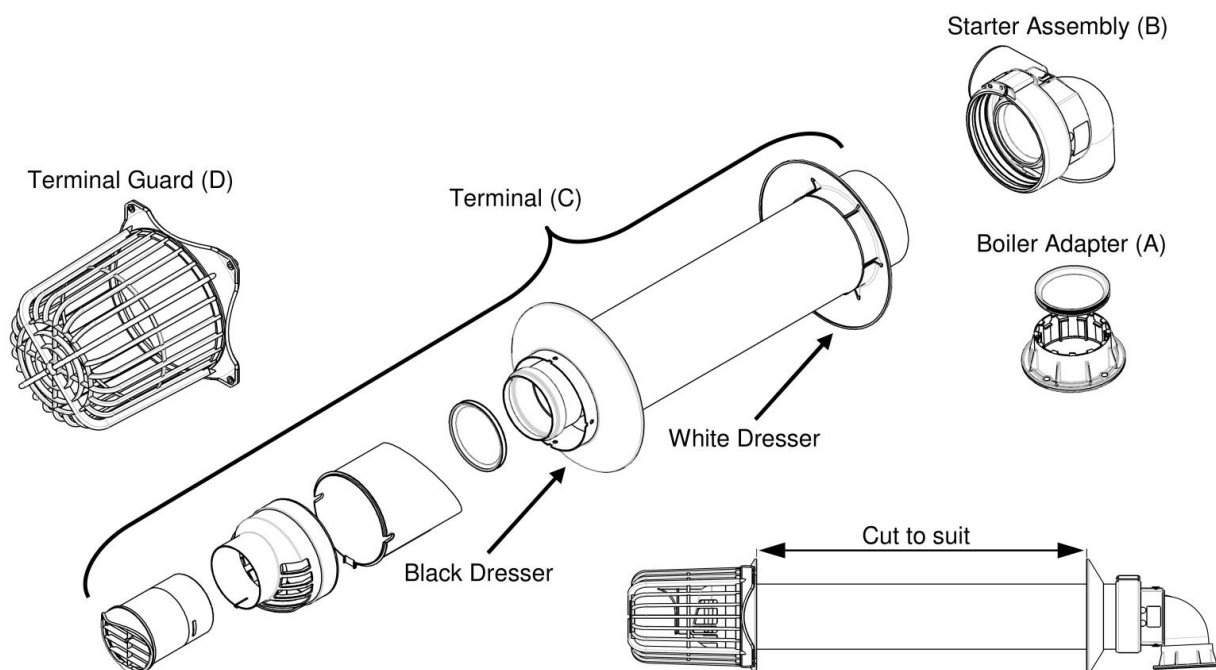

FIT FLUE THERMOSTAT

1. Fit the flue thermostat **BEFORE** fitting the flue kit. Refer to section 8.1.3.

FIT STARTER PIECE

2. Remove the appropriate casing panel cut-out using snips, deburr edges. Ensure the gasket is placed correctly, then fit the boiler adapter using nuts (A).
3. Lubricate the seals then insert the starter assembly (B).

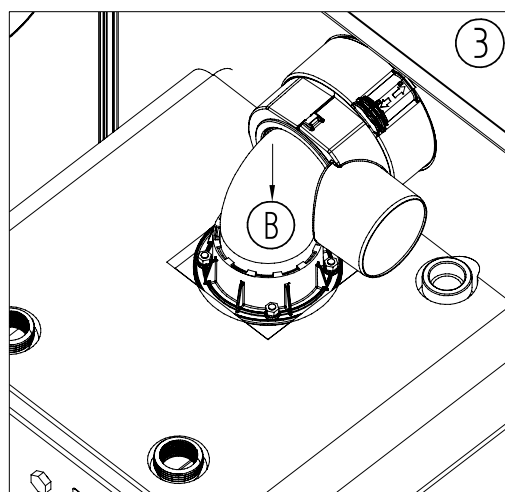
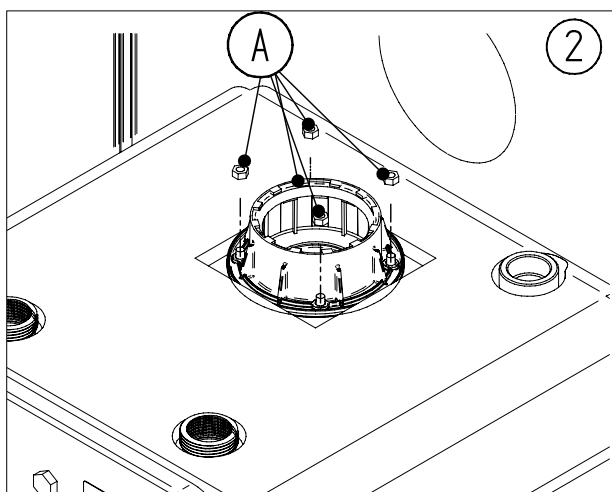

MEASURE AND CUT FLUE TERMINAL

4. Cut a hole through the wall and fit a non-combustible sleeve.
5. Ensure the locking band is open by sliding the clamp to the O (Open) position, lubricate then fit the flue terminal (C) and measure the excess length, X.
6. Remove the terminal, cut X mm from the outer pipe of the terminal then X mm from the inner pipe.

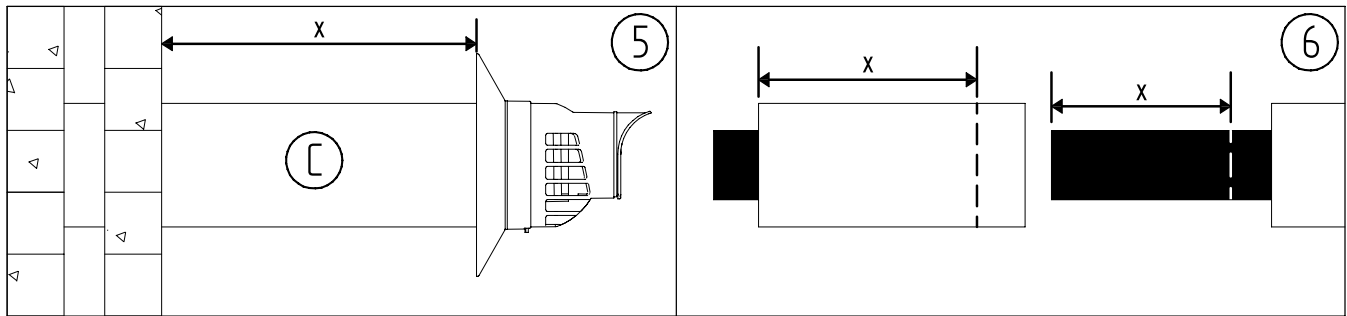

CONNECT TERMINAL AND AIR HOSE

7. Lubricate and refit the terminal ensuring correct orientation, then secure with the locking band. Close the locking band, then slide the clamp to the C (Closed) position, ensuring the flue is secure.
8. Fit the air inlet spigot and gasket to the burner. Attach the flexible air hose to the burner and starter assembly and secure with the jubilee clips.
9. Fit the terminal guard (D) securing in place with suitable fasteners (not supplied).

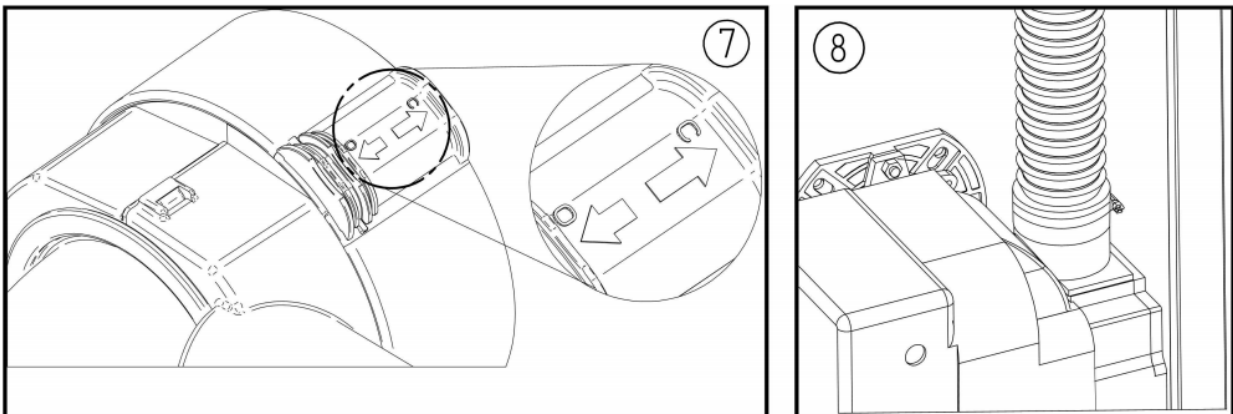

ONLY IF EXTENDING HORIZONTALLY

- i. Cut 30 mm from the outer pipe of the 1st extension only.
- ii. Cut 30 mm from the inner pipe of the flue terminal.

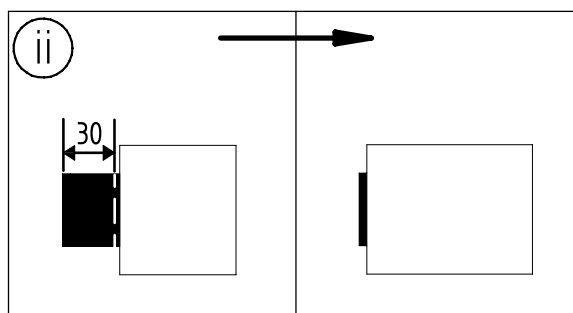
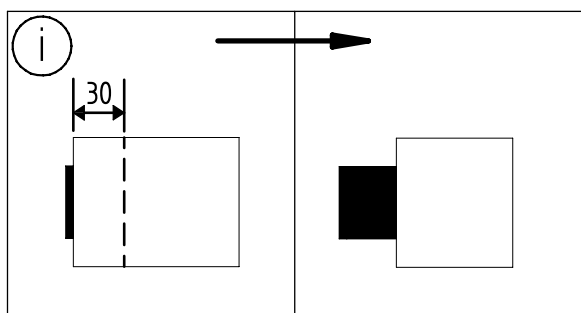
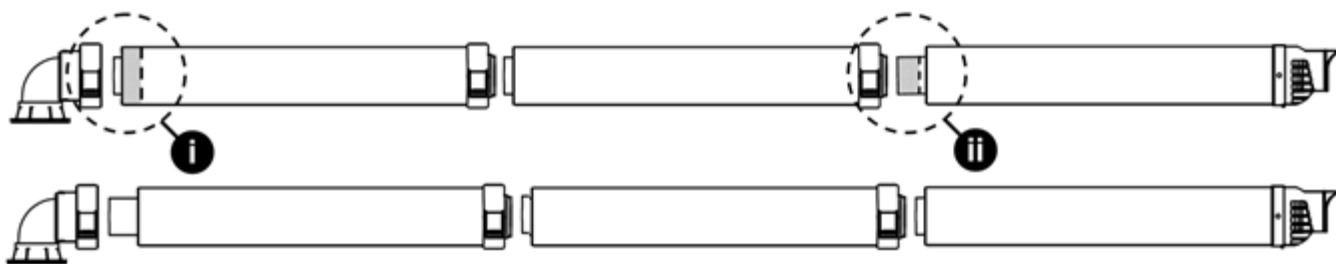

8.1.4 High Level Balanced Flue Kit (HBF)

The kit comprises:

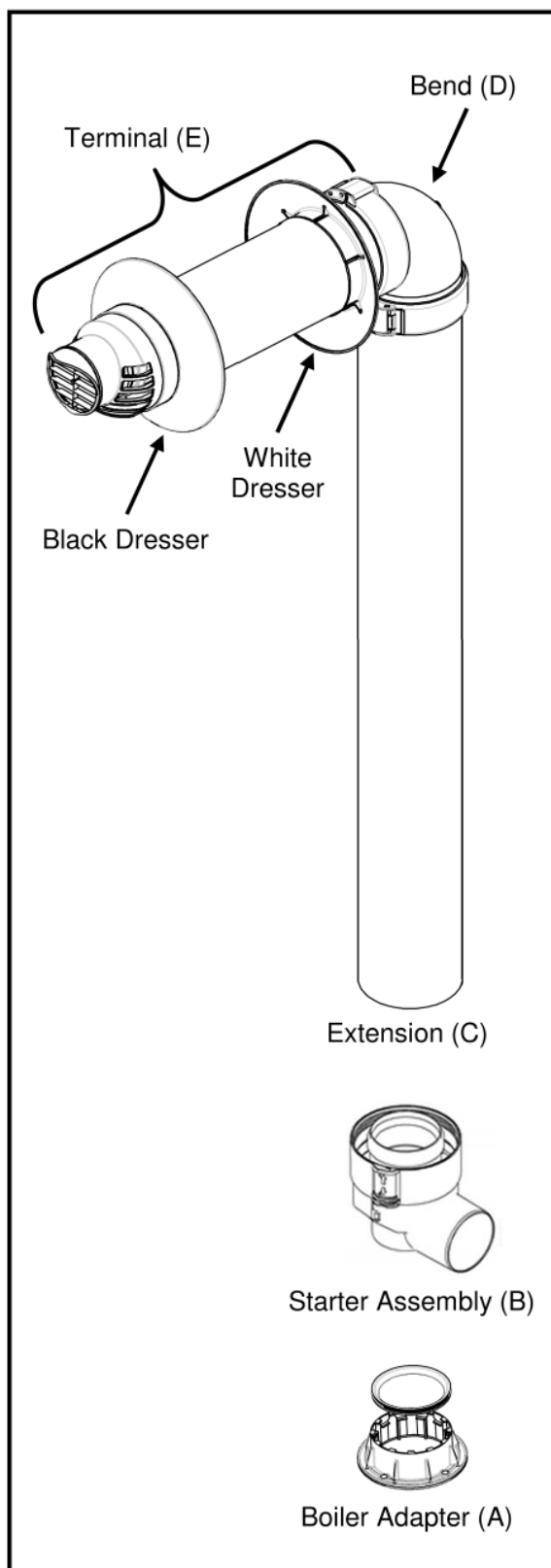

FIT FLUE THERMOSTAT

1. Fit the flue thermostat **BEFORE** fitting the flue kit. Refer to section 8.1.3.

FIT STARTER PIECE

2. Remove the appropriate casing panel cut-out using snips, deburr edges. Ensure the gasket is placed correctly, then fit the boiler adapter using nuts (A).

3. Lubricate the seals, then insert the starter assembly (B).

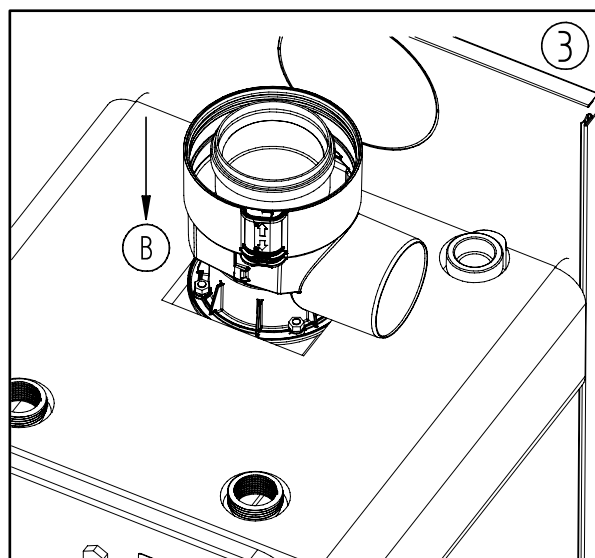
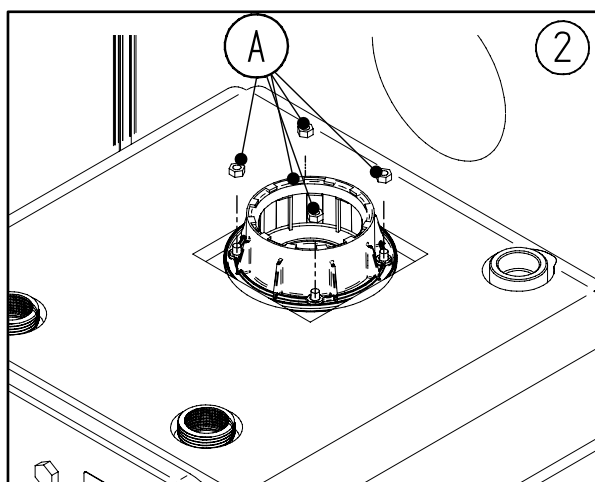

4. Ensure the locking band is open by sliding the clamp to the O (Open) position. Lubricate and fit the first extension (C) and bend (D) as required by the installation. Close the locking bands, then slide the clamps to the C (Closed) position, ensuring the flue is secure.

5. Fit the air inlet spigot and gasket to the burner. Attach the flexible air hose to the burner and starter assembly and secure with the jubilee clips (E) at both ends.

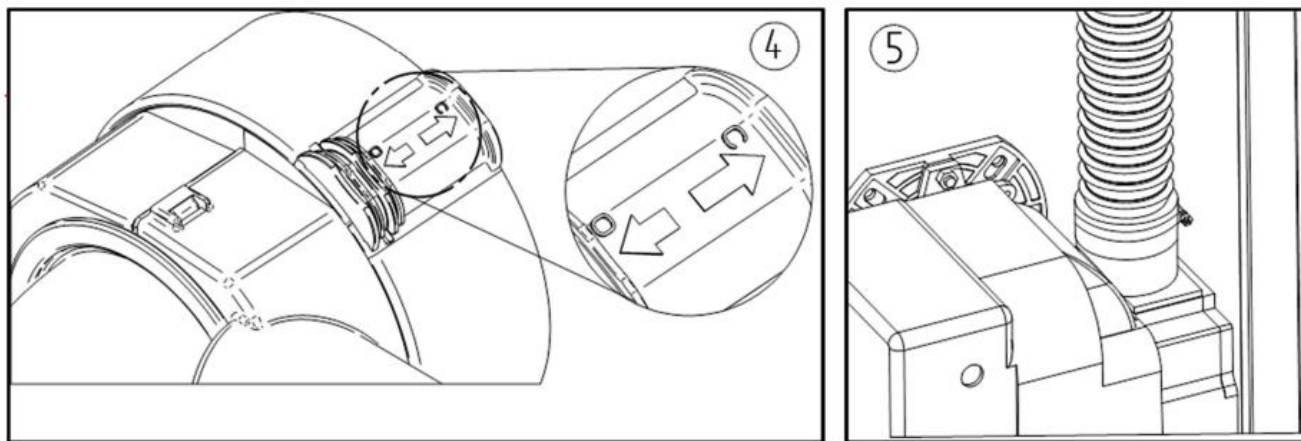

MEASURE AND CUT FLUE TERMINAL

6. Cut a hole through the wall and fit a non-combustible sleeve.

7. Fit the flue terminal (F) and measure the excess length, **X**.

8. Cut **X** mm from the outer pipe of the terminal then **X** mm from the inner pipe.

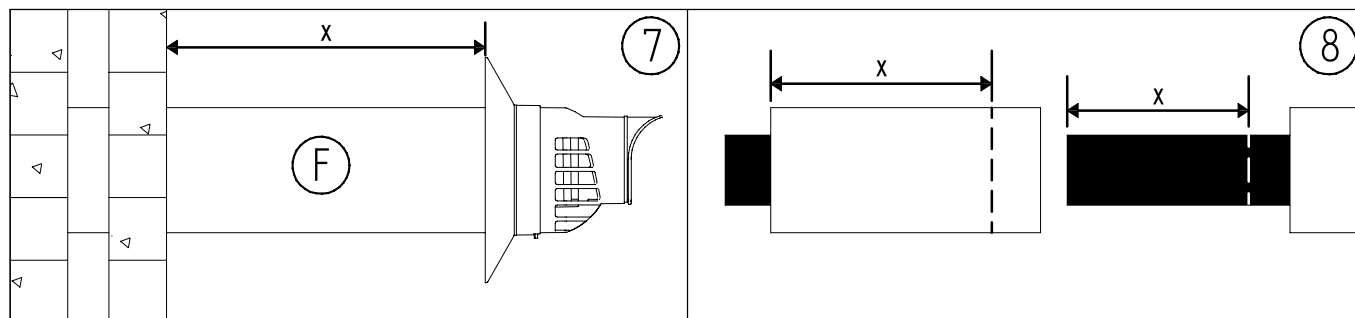

9. Ensure the locking band is open by sliding the clamp to the O (Open) position. Lubricate and refit the terminal. Close the locking band, then slide the clamp to the C (Closed) position, ensuring the flue is secure.

Note: A terminal guard is required if the termination location is less than 2m above external ground level.

8.1.5 Vertical Balanced Flue Kit (VBF)

The kit comprises:

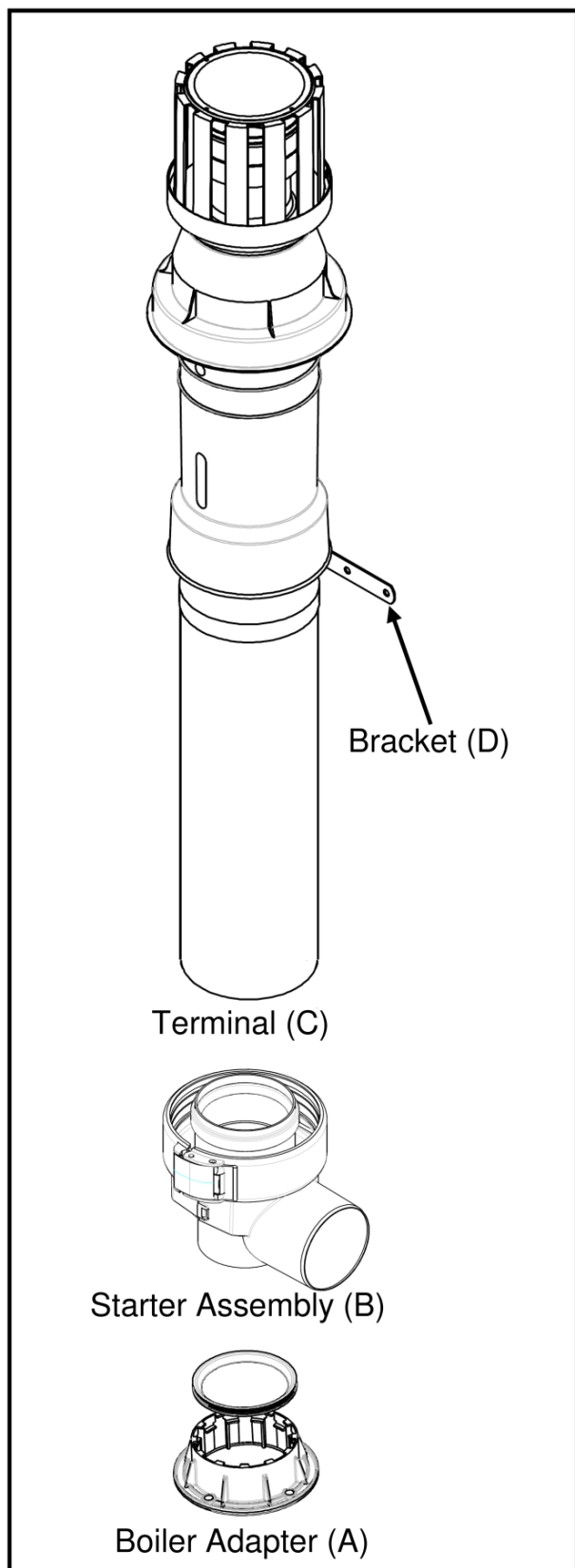

FIT FLUE THERMOSTAT

1. Fit the flue thermostat **BEFORE** fitting the flue kit. Refer to section 8.1.3.

FIT STARTER PIECE

2. Remove the top panel casing cut-out using snips. Fit the boiler adapter using nuts (A).

3. Lubricate the seals, then insert the starter assembly (B).

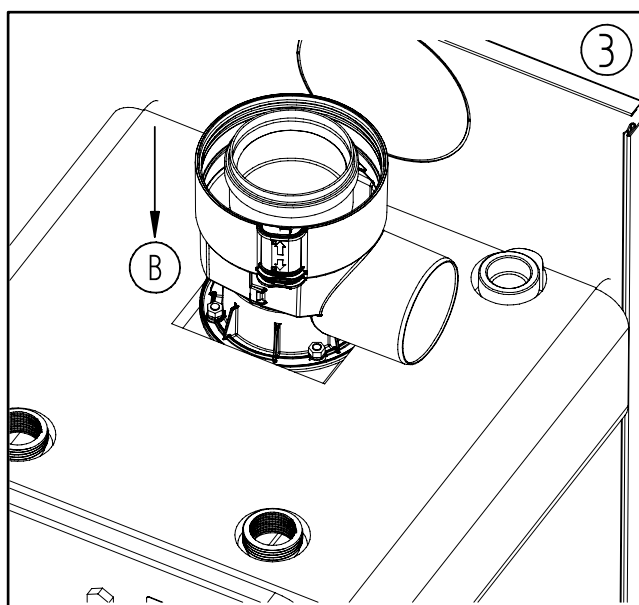
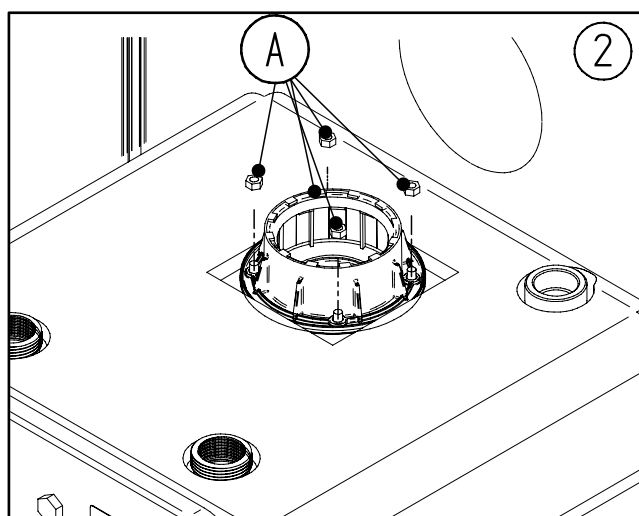

CONNECT 1ST EXTENSION AND AIR HOSE

4. Ensure the locking band is open by sliding the clamp to the O (Open) position. Lubricate and fit the first extension or terminal depending on installation requirements. Close the locking band, then slide the clamp to the C (Closed) position, ensuring the flue is secure.
5. Fit the air inlet spigot and gasket to the burner. Attach the flexible air hose to the burner and starter assembly and secure with the jubilee clips (E) at both ends.

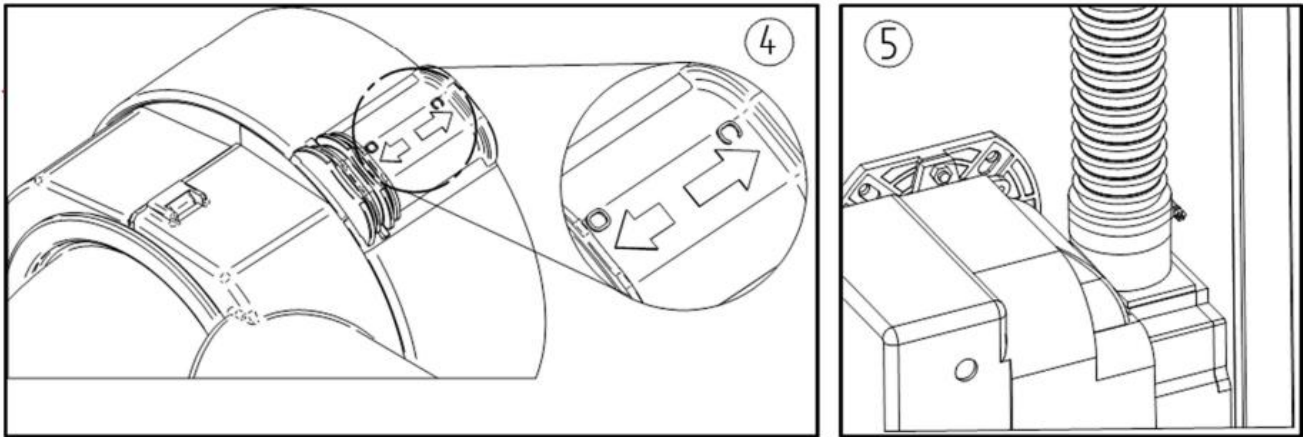

MEASURE AND CUT TERMINAL

6. Fit the flashing and assemble the flue up through the roof, lubricating all seals and securing all locking bands after installation. Measure the excess length, X, noting carefully the correct measurement locations.
7. Remove the terminal, cut X mm from the outer pipe of the terminal (C) then X mm from the inner pipe. Refit the terminal and secure in place with the bracket (D).

